



256 Crighton Building, Crewe Rd, PO BOX 1977,  
Grand Cayman, KY1-1104, Cayman Islands  
Phone: +1 (345) 949-7099  
Fax: +1 (345) 949-6819  
Email: [info@cireba.com](mailto:info@cireba.com)

## Queens Highway House Lot 30ft Asl

North East Coast / Colliers, Grand Cayman

MLS# 419549

**CI\$300,000**

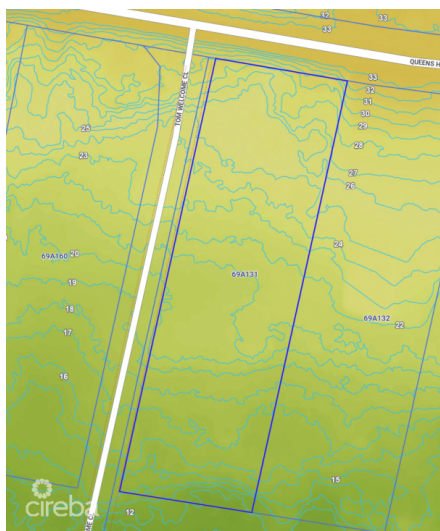

**BRUCE MOORE**  
345-949-7677  
[bruce@rainbow.ky](mailto:bruce@rainbow.ky)

Perched approximately 30 feet above sea level on solid rock, this elevated parcel along Queens Highway in East End offers an exceptional opportunity to build your dream single-family home. Enjoy cooling breezes and the peace of a naturally elevated and secure location. Set in a quiet and peaceful area, this property provides ultimate privacy perfect for those seeking a secluded retreat. A rare opportunity to own in one of Cayman's most tranquil and untouched coastal settings.

## Essential Information

Type	Status	MLS#	Listing Type
Land	Current	419549	Agriculture

## Key Details

Width	Depth
114	378
Acreage	View
1.00	None

## Additional Feature

Zoning	Covenants	Road Frontage	Soil
Agriculture/Residential	No	113	Rock