



256 Crighton Building, Crewe Rd, PO BOX 1977,
Grand Cayman, KY1-1104, Cayman Islands
Phone: +1 (345) 949-7099
Fax: +1 (345) 949-6819
Email: info@cireba.com

Paradise Gardens - House Lot

Savannah / Lower Valley, Grand Cayman

MLS# 418292

CI\$245,000

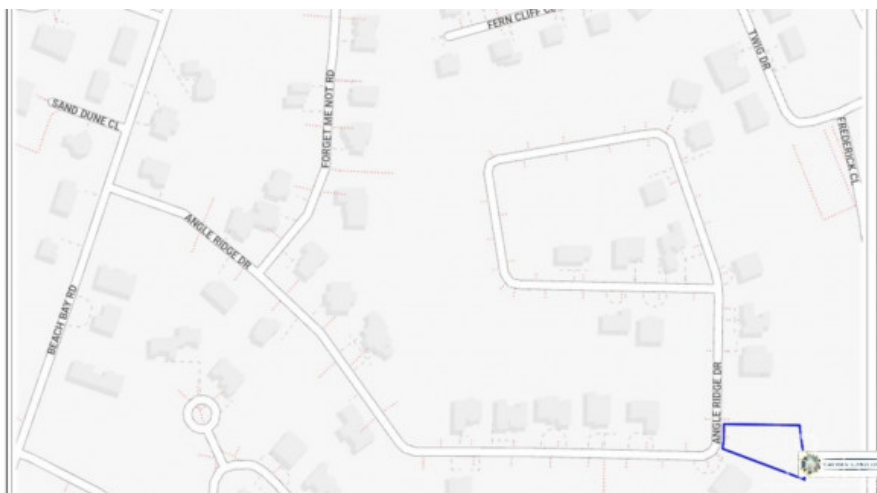

SUSAN BOYKO

345-943-7326

susan.boyko@remax.ky

Paradise Gardens is a tranquil community located at the end of Angle Ridge Drive in Lower Valley. It's an emerging community of single residential homes with plans for a community park within the subdivision. This is the ideal place to raise your family in a peaceful environment. The .3109-acre lot for sale is cleared with fill and widens towards the back, making it the perfect spot for a pool!

Essential Information

Type
Land

Status
Current

MLS#
418292

Listing Type
**Low Density
Residential**

Key Details

The information contained herein has been furnished by the owner and or their nominee and represented by them to be accurate. The listing company, agent and CIREBA MLS disclaims any liability or responsibility for any inaccuracies, errors or omissions in the represented information and all the information contained herein is subject to errors, omissions, price changes, prior sale or withdrawal, without notice and is at all times subject to verification by the purchaser.

Width

83

Depth

170

Acreage

0.31

View

Garden View