



256 Crighton Building, Crewe Rd, PO BOX 1977,
Grand Cayman, KY1-1104, Cayman Islands
Phone: +1 (345) 949-7099
Fax: +1 (345) 949-6819
Email: info@cireba.com

Brac Land .26 Acre With 30ft Vehicle Access Registered/ Electricity On Road

Cayman Brac Centre, Cayman Brac

MLS# 411582

CI\$39,000

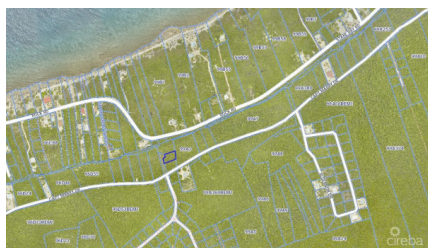

AMBER YATES

345-623-2100

amber@c21cayman.com

This land sits on the North side Bluff some 35 ft above sea level. Stake Bay area. This piece of land is close to amenities and civilization with electricity in place along the road, There is a registered 30ft vehicular right of way over 99A363 in favor of this parcel. Image source: www.caymanlandinfo.ky

Essential Information

Type
Land

Status
Current

MLS#
411582

Listing Type
**Low Density
Residential**

Key Details

The information contained herein has been furnished by the owner and or their nominee and represented by them to be accurate. The listing company, agent and CIREBA MLS disclaims any liability or responsibility for any inaccuracies, errors or omissions in the represented information and all the information contained herein is subject to errors, omissions, price changes, prior sale or withdrawal, without notice and is at all times subject to verification by the purchaser.

Width
140

Depth
87

Acreage
0.26

View
Garden View