



256 Crighton Building, Crewe Rd, PO BOX 1977,
Grand Cayman, KY1-1104, Cayman Islands
Phone: +1 (345) 949-7099
Fax: +1 (345) 949-6819
Email: info@cireba.com

Patrick Island | Windswept Dr Canalfront Lot

Prospect/Spotts, Grand Cayman

MLS# 418288

CI\$479,000

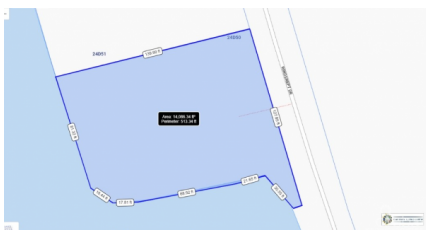
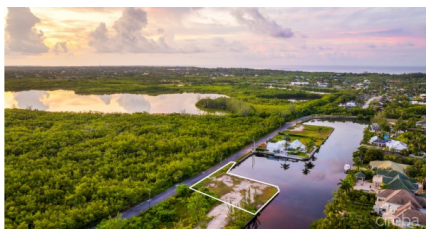

JAMES BOVELL

345-945-4000

james.bovell@remax.ky

This rare parcel has it all – size, location, expansive views & water frontage to two sides! Located in the prominent and established gated community of Patrick's Island, a Boater's Paradise. This 0.3230 acre lot features 239 ft. of water frontage providing a rare opportunity to create a property that will benefit from the expansive southwesterly water view.

This lot is perfect for building your own private home. Provides additional security, privacy, stone seawall and also the best feature is it offers protection for your yacht or multiple boats on both sides of the canal.

Many of the lots in this phase of Patrick's Island have been developed with wonderful homes in the range of 3,000 sq. ft. up to 10,000 sq. ft. as well as mini estates.

Currently, the neighborhood is installing gates and becoming a gated community, with beautiful landscaping. In the future, they will potentially pursue a range of upgrades, such as new community amenities.

Call now for more info!

Essential Information

Type	Status	MLS#	Listing Type
Land	Current	418288	Low Density Residential

Key Details

Width	Depth
102	140
Acreage	View
0.32	Canal Front, Canal View