



256 Crighton Building, Crewe Rd, PO BOX 1977,  
Grand Cayman, KY1-1104, Cayman Islands  
Phone: +1 (345) 949-7099  
Fax: +1 (345) 949-6819  
Email: info@cireba.com

---

## **Sunrise Landing Lot (lake View)**

Savannah / Lower Valley, Grand Cayman

MLS# 420779

**CI\$280,000**

**SITE PLAN**

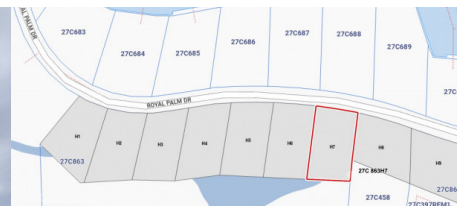



**KRISTINA KING**  
3459456000  
kristina.king@eracayman.com



**JEFF KING**  
jeff.king@eracayman.com

Discover the perfect opportunity to build your dream home in the exclusive community of Sunrise Landing, ideally situated in the heart of Savannah. This exceptional 0.25-acre lakefront lot offers a prime setting within the neighbourhood, creating a peaceful, family-friendly atmosphere. Enjoy the added benefit of close, direct access to the North Sound. With its desirable location and tranquil surroundings, this property provides the perfect balance of privacy and convenience. Just a short drive away, Countryside Shopping Village offers a variety of shops, dining, and everyday essentials, ensuring everything your family needs is within easy reach. Sunrise Landing is a welcoming community designed for comfortable living—making this an outstanding place to create your future home.

## Essential Information

Type <b>Land</b>	Status <b>New</b>	MLS# <b>420779</b>	Listing Type <b>Low Density Residential</b>
---------------------	----------------------	-----------------------	--

## Key Details

Width <b>80</b>	Depth <b>134</b>
Acreage <b>0.2500</b>	View <b>Water View, Lake View</b>